

# Tune VWD

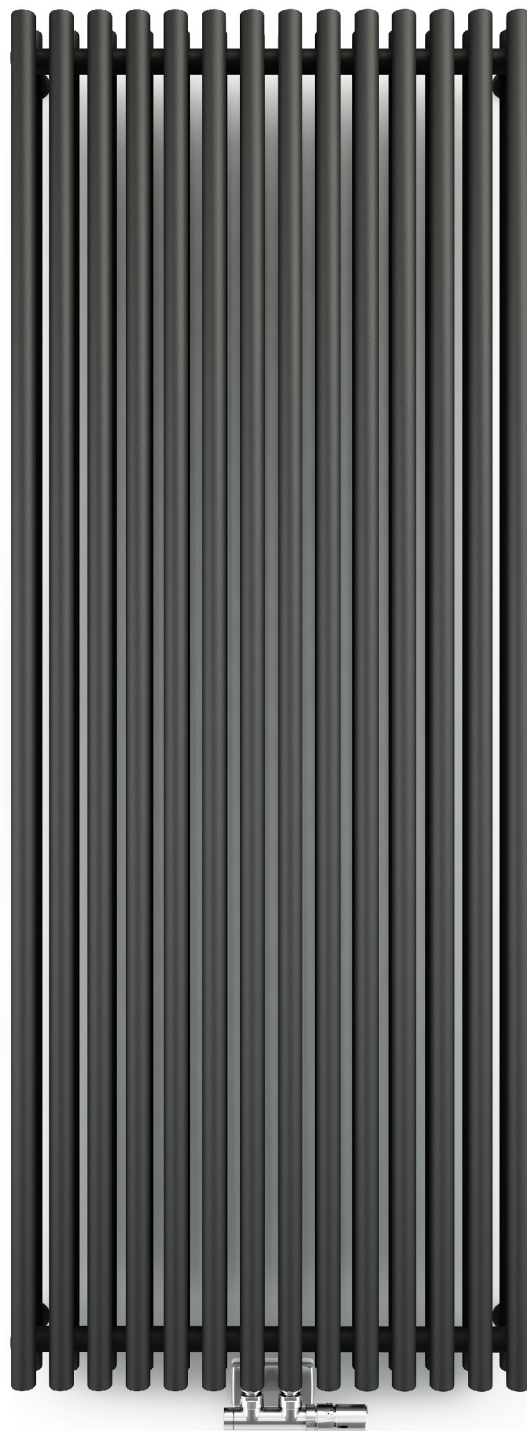

Colour included  
in the price



Tune VWD 1800 x 690  
*colour: soft 9005*

Integrated thermostatic valve, angled, left, chrome  
SLIM thermostatic head, chrome  
Integrated pipe-masking set, chrome



Colour included in the price

design: *Terma*

## Connections:

A ↓ 600÷1800:

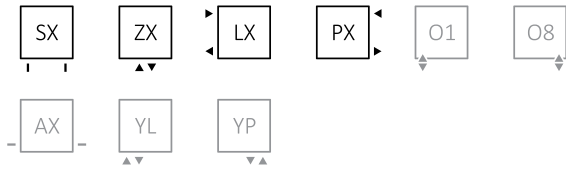

A ↓ 600:

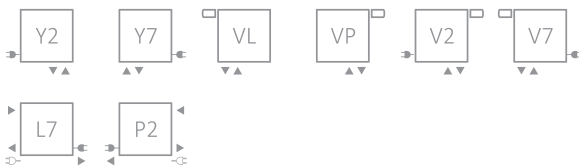

A ↓ 1800:



## We recommend:

A set of integrated thermostatic valves for ZX connection, Z1 i Z8



Integrated pipe-masking set



MEG heating element



## Specifications:

Working pressure: 1,0 MPa    Maximum operating temperature: 95°C

A ↓	B ↔	C1 [mm]	C2 [mm]	C3 [mm]	75/65/20°C [W]	55/45/20°C [W]	⊙ [W]	D [mm]	E [mm]	F [mm]	H [dm³]	⚖️ [kg]	Product Code	Configuration codes: 6
600	590	50	550	500	725	378	800	490	500	50	10,72	15,08	WGTUV060059	
600	790	50	750	500	967	504	1000	690	500	50	14,30	20,08	WGTUV060079	
600	990	50	950	500	1209	630	1200	890	500	50	17,87	25,09	WGTUV060099	
600	1190	50	1150	500	1450	756	1500	1090	500	50	21,45	30,09	WGTUV060119	
600	1390	50	1350	500	1693	883	1500	1290	500	50	25,03	35,09	WGTUV060139	
600	1590	50	1550	500	1934	1008	-	1490	500	50	28,61	40,09	WGTUV060159	
1800	290	50	250	1700	967	489	1000	190	1700	50	15,26	20,81	WGTUV180029	
1800	490	50	450	1700	1612	815	1500	390	1700	50	25,44	34,57	WGTUV180049	
1800	690	50	650	1700	2257	1141	-	590	1700	50	35,62	48,32	WGTUV180069	

# Tune VWD



Colour included  
in the price

## Available sizes:

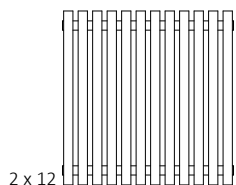

2 x 12

600 x 590

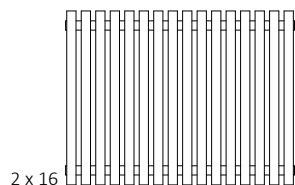

2 x 16

600 x 790

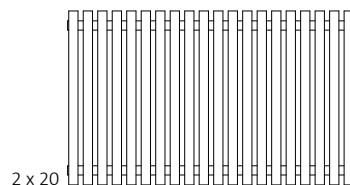

2 x 20

600 x 990

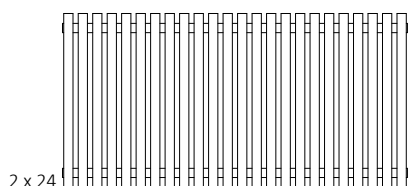

2 x 24

600 x 1190

↕ ↔

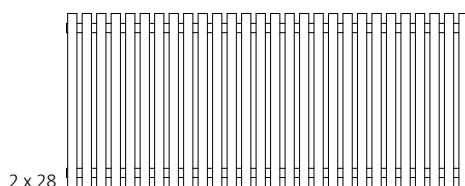

2 x 28

600 x 1390

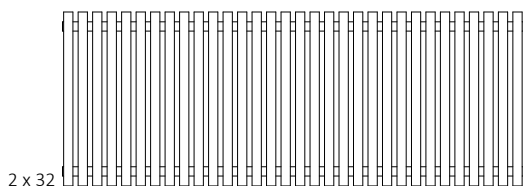

2 x 32

600 x 1590

↕ ↔

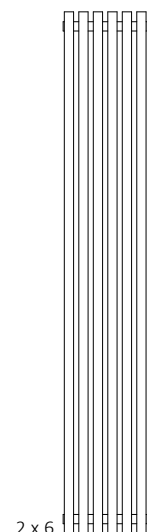

2 x 6

1800 x 290

↕ ↔

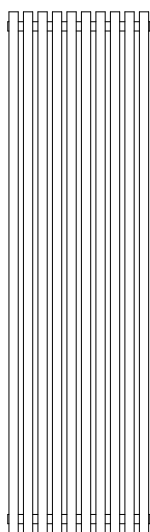

2 x 10

1800 x 490

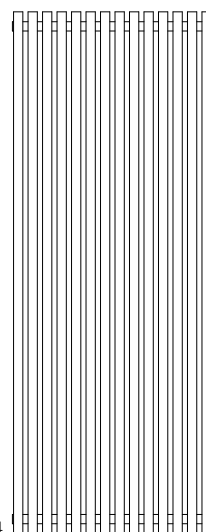

2 x 14

1800 x 690

# Tune VWD



Colour included  
in the price

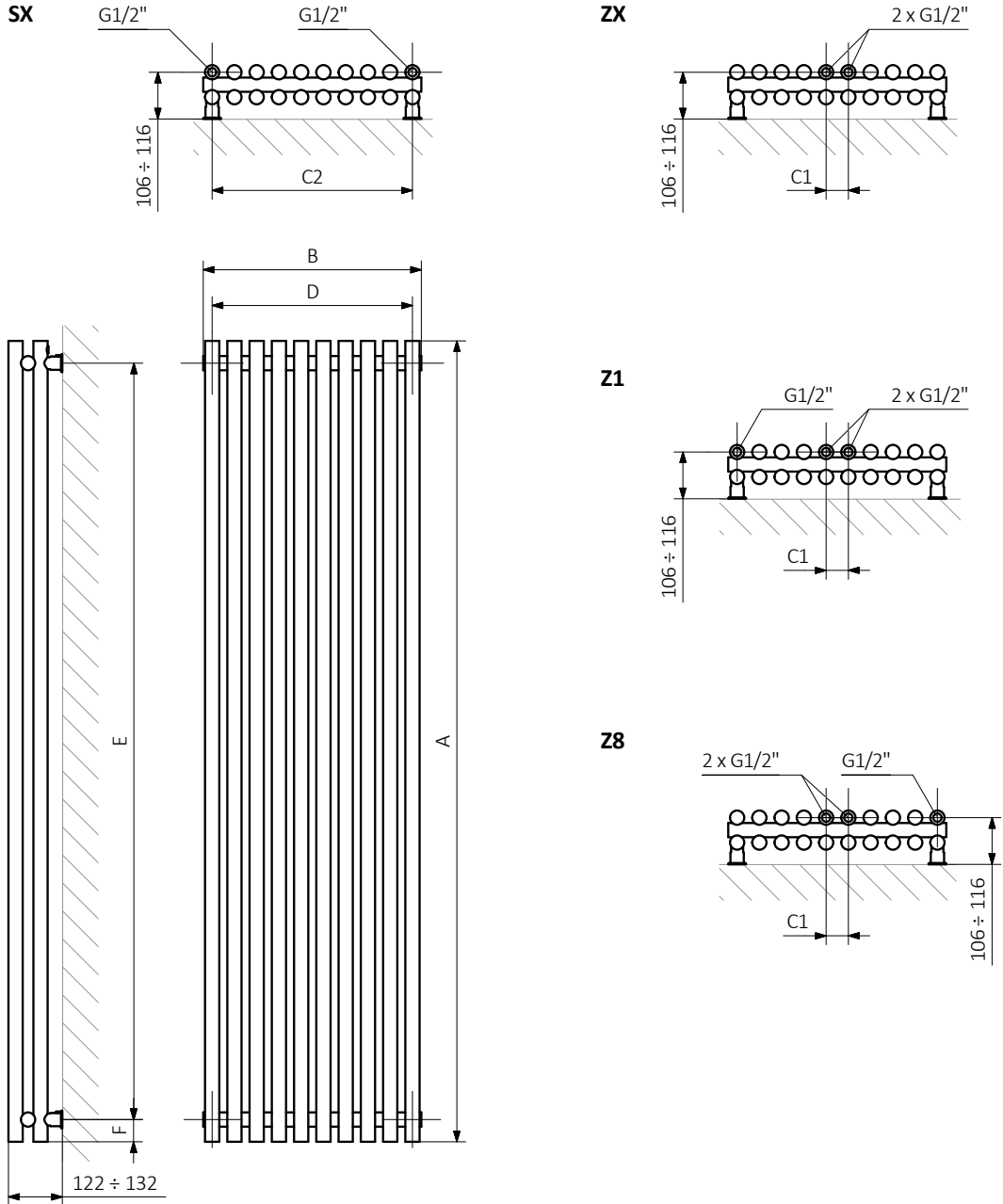

A — Height B — Width C1-C5 — Distance between pipe centres D — Horizontal distance between mounting bracket centres  
E — Vertical distance between mounting brackets F — Distance between a mounting bracket and the bottom of the radiator

Profile:

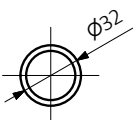

# Tune VWD



Colour included  
in the price

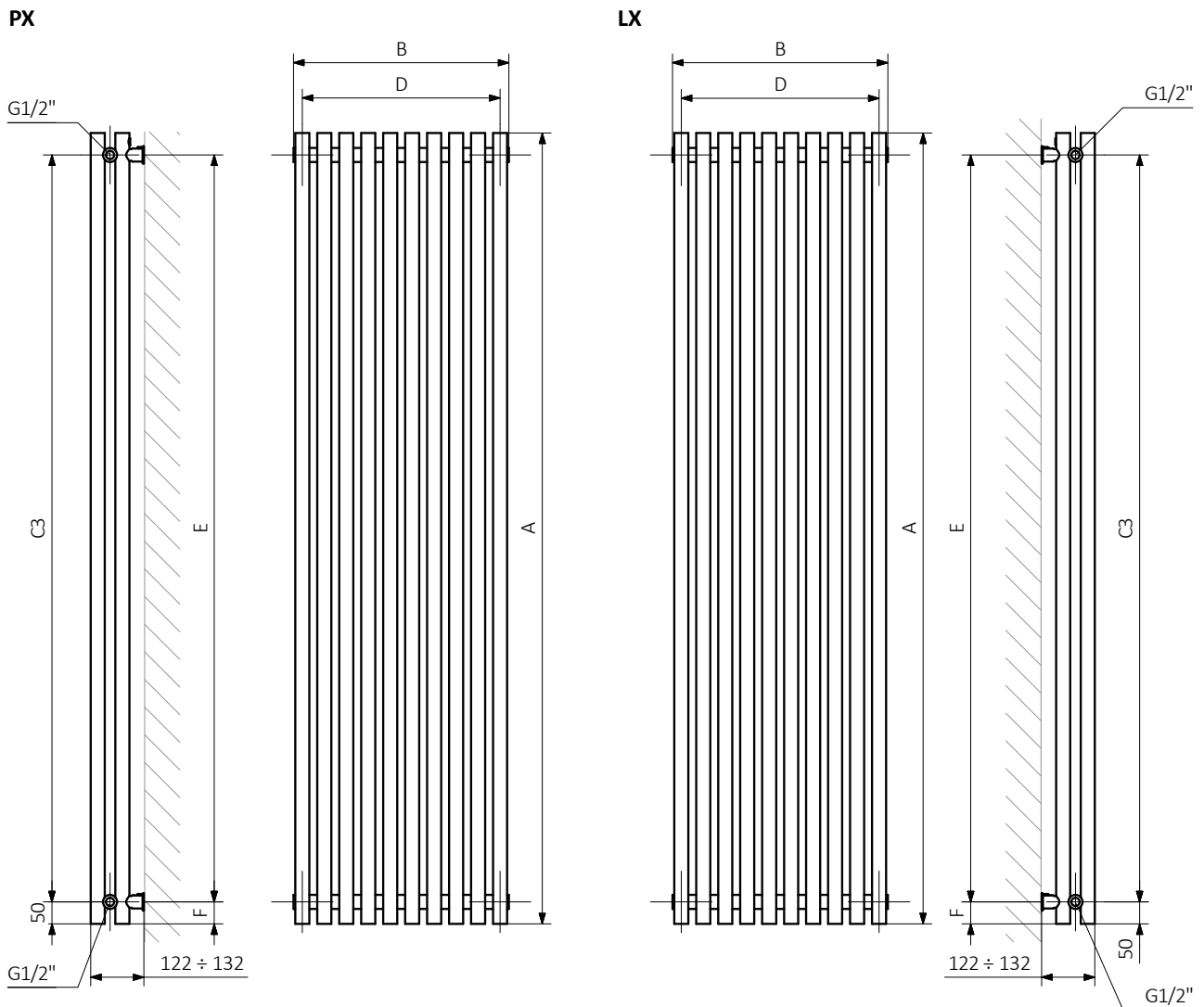

A — Height B — Width C1-C5 — Distance between pipe centres D — Horizontal distance between mounting bracket centres  
E — Vertical distance between mounting brackets F — Distance between a mounting bracket and the bottom of the radiator

Profile:

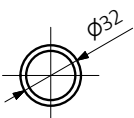

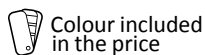

Product codes can be found in product data sheet tables. The codes provide some basic information about the product while a partially filled configuration code contains complementary information about the detailed specifications. When placing an order, product codes should include the fully completed configuration part. The configuration code part should be placed after the main product code. The main product code and configuration part will appear as shown in the example below:

The construction of a water and dual fuel radiator product and configuration code:

WGALE054030

K916SX

PRODUCT CODE  
(located in the table for the product)

CONFIGURATION CODE  
(supplemented by hand)

Configuration

K 916 SX

Package code   Colour code   Connection code  
*K – carton box*

Zinc powder primer

**C** – Code of zinc powder primer is an extra processes

WLALE054030 K916SX **C** — *Extra processes or additions code*

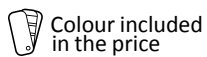

## Legend



Available in chrome finish.



Radiator available in a "water" version.



Radiator suitable for dual fuel connection. Electric heating element can be installed.



Radiator available in electric only version. It comes prefilled with a 'heating medium' and equipped with a heating element. All tested and ready to use.



Connection types dedicated for this radiator.  
The icon shows the flow and return connections for the radiator as well as the thermostatic valve and heating element position if applicable.



Optional connections available for this radiator.



Suggested heating element power output for electric and dual fuel versions.



Weight.



Capacity.