

Perta E Class I Electric version with a heating wire.



Colour included in the price

design: *Terma*

Connections:



Available sizes:

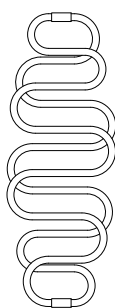

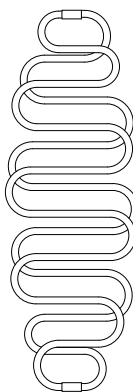

1360 x 500
 ↓ ←



1760 x 600

Specifications:

Electric version with a heating cable.

A ↓	B ↔	 [W]	D [mm]	E [mm]	F [mm]	 [dm ³]	 [kg]	Product Code <small>Configuration codes: 3</small>
Powder coating								
1360	500	427	160	600	340	–	13,20	WSPER136050
1760	600	632	290	600	540	–	18,10	WSPER176060
Plated finishes								
1360	500	213	160	600	340	–	13,20	WSPER136050
1760	600	284	290	600	540	–	18,10	WSPER176060

Pera E

Class I Electric version with a heating wire.



Colour included in the price

EX

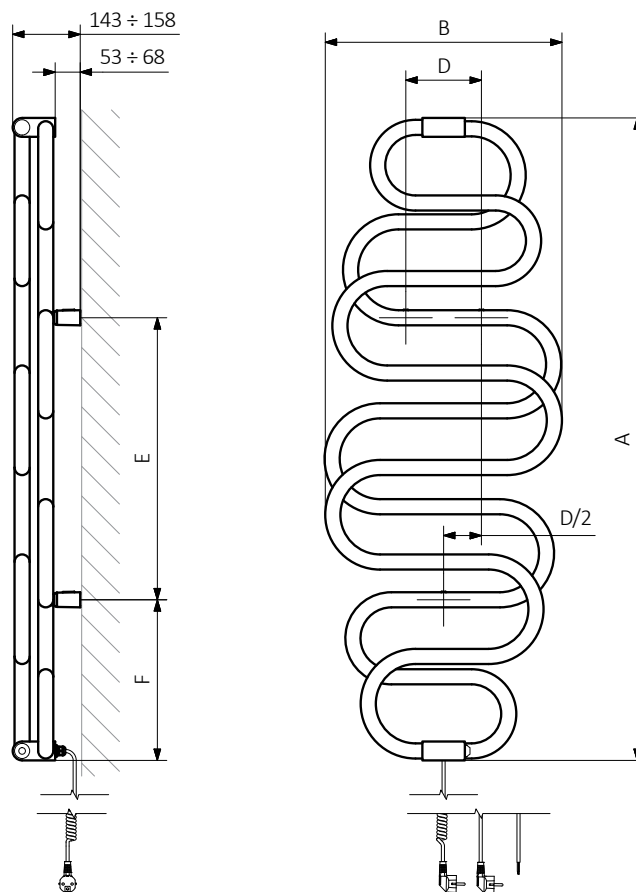

A — Height B — Width C1-C5 — Distance between pipe centres D — Horizontal distance between mounting bracket centres
E — Vertical distance between mounting brackets F — Distance between a mounting bracket and the bottom of the radiator

Profile:

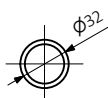



Colour included
in the price

Product codes can be found in product data sheet tables. The codes provide some basic information about the product while a partially filled configuration code contains complementary information about the detailed specifications. When placing an order, product codes should include the fully completed configuration part. The configuration code part should be placed after the main product code. The main product code and configuration part will appear as shown in the example below:

Structure of configuration code for electric radiators with a heating wire

WWBNN076050

PRODUCT CODE
(located in the table for the product)

K916E1W

CONFIGURATION CODE
(supplemented by hand)

Configuration

K 916 E1 W

Package code Colour code Connection code Type of heating element cable code
K – carton box

Zinc powder primer

C – Code of zinc powder primer is an extra processes

WLAL054030 K916SX **C** – *Extra processes or additions code*

Perta E

Class I Electric version with a heating wire.



Colour included in the price

Legend



Available in chrome finish.



Radiator available in a "water" version.



Radiator suitable for dual fuel connection. Electric heating element can be installed.



Radiator available in electric only version. It comes prefilled with a 'heating medium' and equipped with a heating element. All tested and ready to use.



Connection types dedicated for this radiator.

The icon shows the flow and return connections for the radiator as well as the thermostatic valve and heating element position if applicable.



Optional connections available for this radiator.



Suggested heating element power output for electric and dual fuel versions.



Weight.



Capacity.